

mainstation®

MAINSTATION INSTALLATION KIT INSTRUCTIONS

MODEL: MS-21-IK, PS-9015

1 Review all the instructions and plan your installation.

NOTE: Should it be beyond one's qualifications to install this kit, it is left to the customer to hire licensed individuals to perform the work, including the hiring of an electrician to run all electrical cables and perform all AC electrical mains connections.

CHECK THAT ALL COMPONENTS ARE INCLUDED

Component	Image	QTY
Mainstation Installation Kit Power Supply Unit (PSU)		1
Top and Bottom Rail		2
Side Brackets with screws		2
Cable tie with cable tie mount		1
Electrical Connectors (Pre-attached)		3
Wire Clamp (Pre-attached)		1
#6x1" Screws		3
#8x3" Screws		2

REQUIRED TOOLS

- #1 Phillips screw driver
- #2 Phillips screw driver or drill w/#2 driver
- Wire cutter and stripper
- Tape measure
- Drywall saw (For retrofit installation only)

2 Determine positioning and height of MS-21. Measure and mark the height on both studs. These marks will be used to help ensure the frame is level.

NOTE: The top edge of the MS-21 is 5/8" (16mm) above the upper opening of the installation frame.

- For Retrofit Construction Only** – Determine installation location. Use a stud finder to aid in locating the studs. Cut hole to full width of studs and to height of frame. Height = 6.5" (165mm).
- The **maximum width** of the adjustable installation frame is 15.5" (394mm).
- The **minimum width** of the adjustable installation frame is 14" (355mm).
- The **minimum opening width** required for installing the MS-21 (without frame) is 13.8" (351mm).

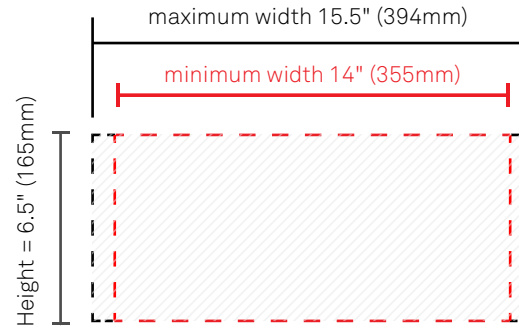

3 Measure the spacing between studs.

Assemble side brackets to top and bottom rails and adjust width to fit within stud spacing.

- Reducing the width by 1/16" (1.5mm) will make the frame easier to fit into place.
- Secure the screws on the top and bottom rails to lock adjustment into place, (4 screws total).

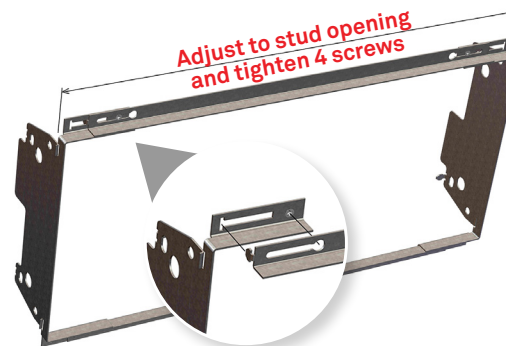

4 Place frame between studs and secure using the three 1-inch (25mm) screws. While there are 4 holes, the screw where the power supply unit (PSU) will be installed is omitted.

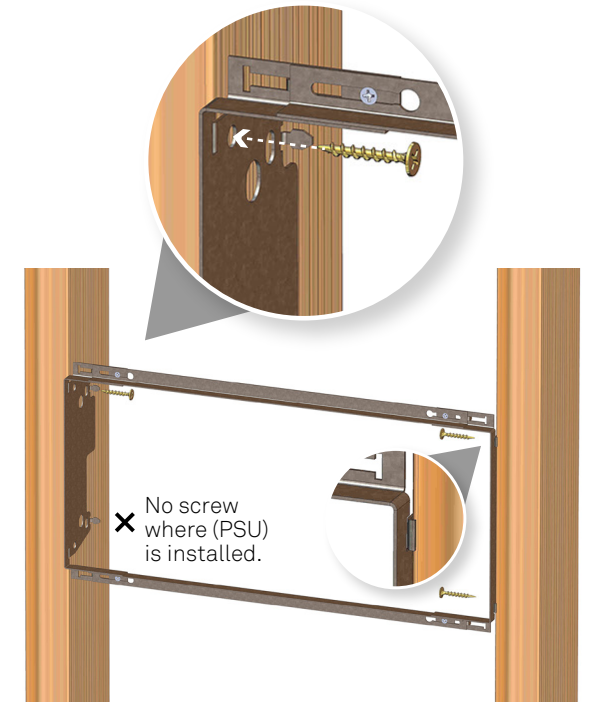

5 Black Wire Clamp can be replaced as needed for commercial installations.



Model: PS-9015, MS-21-IK
 Input 100-240VAC 1.9A 50/60Hz
 Output: 15V = 4A

Ambient temperature tested:
 -20 to 45 celsius degree,
 Altitude 2000m



RoHS



xxx-xxxxxx-xx

INSTALLATION KIT INSTRUCTIONS

- 6** Place the PSU onto the two tabs of the frame using the most-rearward holes of the PSU.

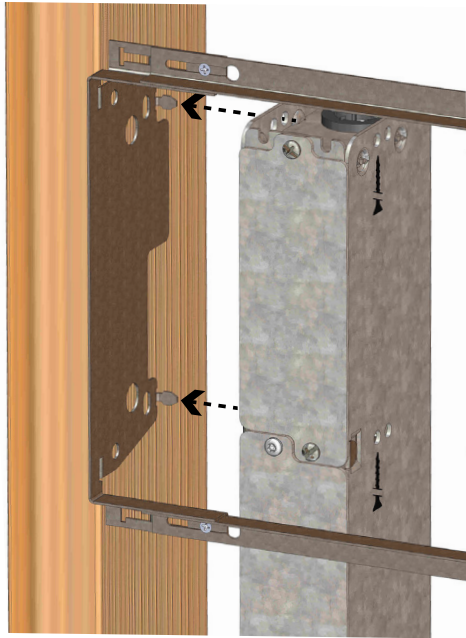

- ❑ The PSU can be mounted in 4 different configurations, (left side, up or down, & right side, up or down).

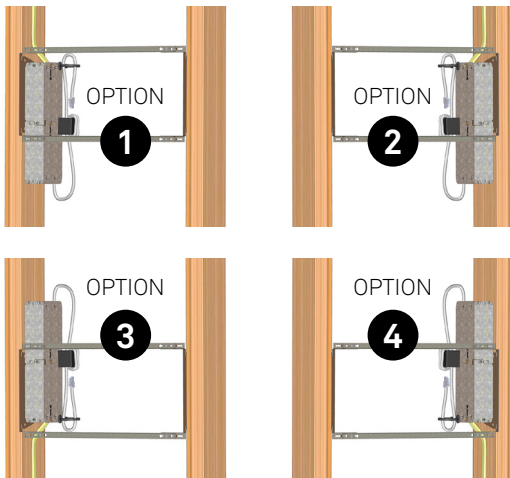

- 7** Install the two 3-inch (75mm) screws to secure the PSU.

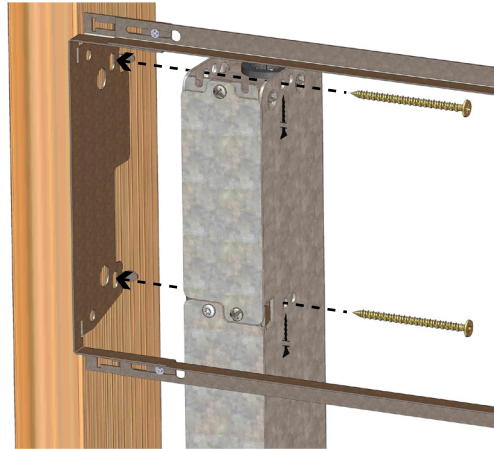

- 8** **WARNING! Read the Hazard Warning document before proceeding. Failure to follow safe practices can lead to serious injury or death. Utilize a licensed electrician where available.**

- ❑ Using the 3 supplied WAGO® electrical connectors, connect the mains electrical power to the PSU.
- ❑ Strip insulation from the wire exposing **3/8" (11mm)** of each conductor. Flip up the orange tabs of the connector, insert the wire, and flip the tabs down.
- ❑ Connect the earthing wire before connecting the L/N Wire. When disconnecting wires, disconnect the earthing wire only after disconnecting the L/N wires.
- ❑ The Green/Yellow wire is Earth/Ground. Connect it to the bare conductor of the sheathed cable.*
- ❑ The Black wire is Line/Hot. Connect it to the black conductor of the sheathed cable.
- ❑ The White wire is Neutral. Connect it to the white conductor of the sheathed cable.

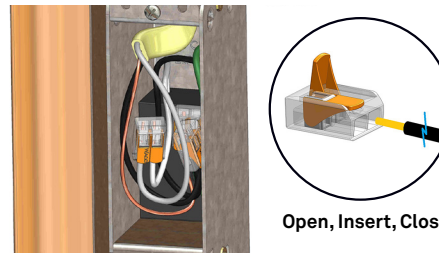

*This provides connection of the equipment protective earthing conductor to the installation protective earthing conductor.

- 9** Ensure all wiring is in place and the electrical cover is secured.

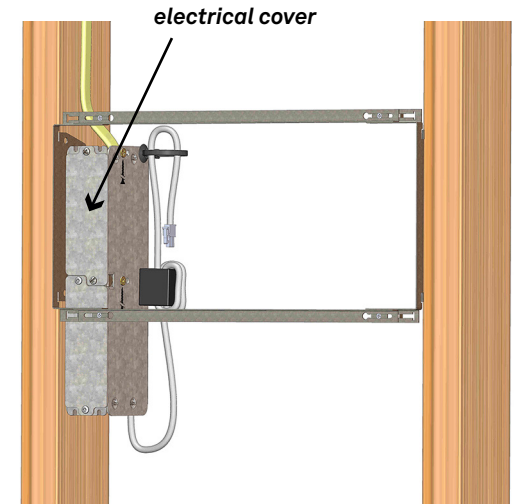

- 10** Insert cable tie mount and cable tie. Use these to support the speaker wires and other cabling that will be connected to the MS-21. Looping the PSU DC-output cable in and out of the cable tie can hold it in place temporarily until the MS-21 is ready for installation.

